

Available on  
Drug Tariff from  
1st September 2011



**SUMED**  
**Cilguard**<sup>®</sup>  
Polyurethane foam dressing  
with soft silicone adhesion  
Latex Free

Dressings with a difference!

# A **NEW** range of polyurethane foam dressings featuring our innovative Cilguard® Overlap.

Cilguard® is a range of polyurethane foam dressings with soft silicone adhesion, gentle enough to suit the most delicate skin, effective enough to deal with the most challenging of chronic wounds - saving you money too.

Industry-leading absorbency and moisture vapour transmission helps Cilguard® to minimise the risk of both maceration and dressing saturation:

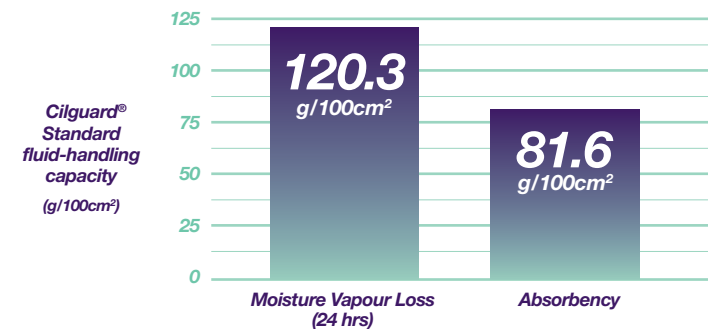

As well as the Standard and Border variants, the range includes our innovative and unique Cilguard® Overlap.

## Cilguard® Overlap - specially designed for large wounds and awkward areas!

Developed in response to clinical feedback, this innovative dressing has a 2cm adhesive overlap on one edge for joining to other dressings. And because it doesn't touch the skin, the adhesive on the overlap can be much stronger for a more secure dressing with less leakage.



Cilguard® Overlap

Cilguard® Overlap is particularly useful on fragile skin conditions, such as Epidermolysis Bullosa (EB), where large and awkward areas have to be covered. It's also ideal for flexible areas like elbows or knees where the overlap forms a hinge.

**All you have to do is PEEL and JOIN to create the ideal large dressing.**

For every pack of Cilguard® sold SUMED® will make a charitable donation to DebRA!

## Cilguard® Standard

Cilguard® Standard consists of a soft silicone contact layer, a flexible absorbent pad made of polyurethane foam and an outer film which is vapour permeable and waterproof.



Cilguard® Standard

## Cilguard® Border

Cilguard® Border is an island dressing which extends 2cm on all sides beyond the edge of the absorbent pad.



Cilguard® Border

### Before use

1. Cleanse the wound.
2. Dry the surrounding skin thoroughly.
3. Cut the dressing to size if required.

### How to apply

Cilguard® can be left in place for several days depending on the level of exudate and general condition of the wound.

4. Remove the release papers and apply the adherent side to the wound surface:

#### Cilguard® Standard

Allow an overlap of at least 2cm around the wound edge.



#### Cilguard® Border

Fix the border around the wound edge.

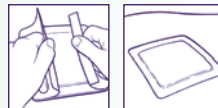

#### Cilguard® Overlap

Fix the adhesive overlap to adjoining dressings.

**Note:** The overlap should NOT be adhered directly onto the skin. The overlap section can be easily removed or folded back on itself if not required.



### Dressing removal

5. Lift one corner of the dressing and gently peel back. Adhesive removal sprays/wipes can be used if required.

Manufactured by: Himedica Ltd, Unit B, Tarvin Sands, Chester, Cheshire, CH3 8JF

Distributed exclusively by:

**SUMED**®

Sumed International (UK) Ltd  
Integrity House, Units 1-2 Graphite Way  
Hadfield, Glossop, Derbyshire SK13 1QH  
Telephone: 01457 890980 Fax: 01457 890990  
Email: sales@sumed.co.uk

[www.sumed.co.uk](http://www.sumed.co.uk)

Cilguard is a registered Trademark of Sumed International (UK) Ltd.

**PLUS**  
Cilguard® is  
less expensive  
than the current  
market-leading  
equivalent!



### Ordering details

Stock Number	Dressing Size	Pack Qty	PIP Code	Drug Tariff Price (per dressing)
<b>Cilguard® Standard</b>				
CGS10105	10cm x 10cm	5	366-4588	£2.10
CGS15155	15cm x 15cm	5	366-4596	£3.50
CGS20105	20cm x 10cm	5	366-4604	£2.90
CGS20205	20cm x 20cm	5	366-4612	£6.50
CGS20502	20cm x 50cm	2	366-4620	£24.50
CGS10602	10cm x 60cm	2	366-4638	£12.60
<b>Cilguard® Border</b>				
CGB10105	10cm x 10cm	5	366-4646	£2.05
CGB15155	15cm x 15cm	5	366-4653	£4.20
CGB20105	20cm x 10cm	5	366-4661	£3.48
CGB20205	20cm x 20cm	5	366-4679	£6.48
CGB20502	20cm x 50cm	2	366-4687	£24.50
<b>Cilguard® Overlap</b>				
CGL10105	10cm x 10cm	5	366-4547	£2.10
CGL15155	15cm x 15cm	5	366-4554	£3.50
CGL20105	20cm x 10cm	5	366-4562	£2.90
CGL20205	20cm x 20cm	5	366-4570	£6.50